



شركة المصنع السعودي لأجهزة الإطفاء
SAUDI FACTORY FOR FIRE EQUIPMENT Co.

Empowering
a Safer Future for
the Kingdom



Fire Cabinets SF900 Series

VERTICAL DOUBLE COMPARTMENT
CABINET FOR VARIOUS
FIRE EQUIPMENTS

- ❖ Recessed type cabinets
- ❖ Semi-Recessed type cabinets
- ❖ Surface type cabinets
- ❖ Self Stand type cabinets

Quality Approvals for Various Products and Services

VER: 00-12/25

Fire Cabinets

Model: SF 900 Series



Model: SF900

The SFFECO Fire Cabinet SF900 Series is engineered with a smart dual-compartment configuration that seamlessly combines efficiency, versatility, and ease of access. One vertical compartment is dedicated to a semi-rigid fire hose reel, ensuring fast and effective response during emergencies, while the second compartment is thoughtfully designed to accommodate fire extinguishers and synthetic hoses. With its well-organized internal layout, robust construction, and clean, professional appearance, the SF900 Series delivers a complete, reliable, and highly visible fire protection solution suitable for a wide range of commercial, industrial, and public environments.

- ❖ Cabinets are manufactured from Mild Steel or Stainless Steel material with a thickness of 0.9mm to 2.0mm which depends on usage or customer request.
- ❖ Back box, Door and Frame can be of different thickness and material.
- ❖ The cabinets are available with all around folded edges without any sharp edges.
- ❖ Optional Hairline or Mirror finish Stainless Steel cabinets are also available.
- ❖ Cabinets are painted with Powder Coated for elegant finish and protection from rust.
- ❖ Operation Instructions are silk screen printed in Arabic and English languages inside the cabinet.
- ❖ Hose Reels in cabinets are fully equipped with landing valves and nozzles.
- ❖ Cabinets are available in different size and design to meet architectural requirements.
- ❖ Cabinets can be surface mounted, recessed or semi-recessed types.
- ❖ Rubber Hose of 30 meter available in manual or automatic models.
- ❖ Hinges are available with Piano type / Bush Pin Hinges / Concealed Pin Hinges as per requirement.
- ❖ Pressure Reducing Valve or Lock Shield Valve are available upon request.

Item	Specification
Body Material (SF 900 Series)	Mild Steel
Body Material (SF 900S Series)	Stainless Steel #304
Thickness	0.9mm / 1mm / 1.2 mm / 1.5 mm / 2.0mm
Mounting Type	Wall Mounted (Recessed / Surface / Semi-Recessed)
Finish	Red Powder Coated (RAL 3000)
Markings	Operation instructions printed on the door

- ❖ Other material types are available upon request.
- ❖ Cabinets in stainless steel are available with hairline or mirror finish as per customer request.

Fire Cabinets

Model: SF 900 Series

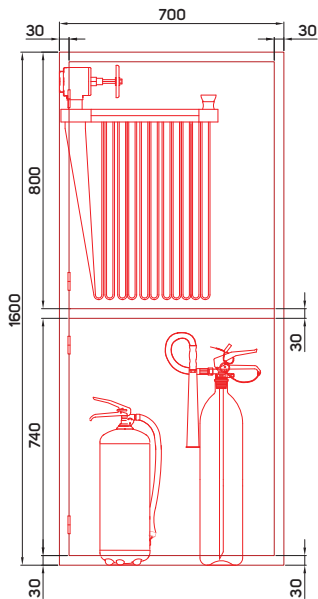

Option 1:

- Semi Automatic Hose Rack : 1.5" \varnothing x 30 meter
- Jet & Spray Nozzle : 1.5"
- Angle Valve : 1.5"
- Fire Extinguisher : 5 Kg CO2
- Fire Extinguisher : 6 Kg Dry Powder

Width (mm)	Height (mm)	Depth (mm)
700	1600	250

Note: The dimensions are for the back box only. In case of recessed or semi-recessed cabinets, the frame size will be added on top of the back box size.

Option 2:

- Semi Rigid Fire Hose Reel : 25mm \varnothing x 30 meter
- Jet & Spray Nozzle : 1"
- Landing Valve : 1.5"
- Fire Extinguisher : 5 Kg CO2
- Fire Extinguisher : 6 Kg Dry Powder

Width (mm)	Height (mm)	Depth (mm)
800	1600	250

Note: The dimensions are for the back box only. In case of recessed or semi-recessed cabinets, the frame size will be added on top of the back box size.

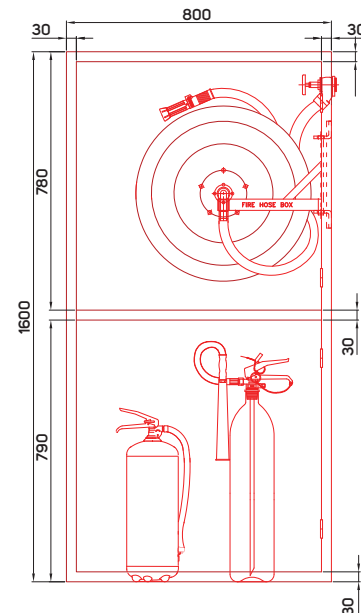

Option 3:

- Semi Rigid Fire Hose Reel : 25mm \varnothing x 30 meter
- Jet & Spray Nozzle : 1"
- Landing Valve : 1.5" & 2.5"
- Synthetic Hose with Coupling : 2.5" x 30 meter
- Jet Nozzle : 2.5"
- Fire Extinguisher : 6 Kg Dry Powder

Width (mm)	Height (mm)	Depth (mm)
800	1500	300

Note: The dimensions are for the back box only. In case of recessed or semi-recessed cabinets, the frame size will be added on top of the back box size.

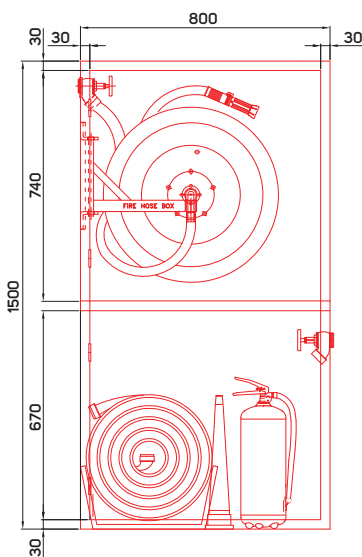

Note: Fire Blanket or Fire Axe can be fitted in place of Extinguisher. Extinguisher sold separately.

Semi Rigid Fire Hose Reel and Accessories



Semi Rigid Fire Hose (Kitemark Approved)

- ❖ Model : SH19R and SH25R
- ❖ Size : \varnothing 3/4" and 1" (\varnothing 19mm and \varnothing 25mm)
- ❖ Hose Length : 30 Mtr
- ❖ Work Pressure : 12 Bar
- ❖ Approval : BS EN-694:2014 Standard
- ❖ Hose Color : Red



Fire Hose Reel

- ❖ Model : SF 30 SA - 25 (Manual)
SF 30 A - SA - 25 (Automatic)
- ❖ Type (Standard) : Swinging Arm Type
- ❖ Type (Optional) : Fixed Type / Swinging Pipe Type
- ❖ Hose Length : 30 Mtr
- ❖ Approval : BS EN-671 / Sffeco Standard
- ❖ Swinging Angle : 180° (for Wall Mounted)
- ❖ Reel Diameter : 580mm
- ❖ Hose Color : Red (Other colors are available on request)
- ❖ Paint Finish : Electrostatic powder coat



Note: EN 671 Approved Hose Reels are provided with Plastic Nozzle and 1" Ball Valve & Nipple.

Nozzle



- ❖ Body: Brass & Chrome Plated
- ❖ 3 way control
(Jet - Spray - Shut off)

Landing Valve



- ❖ Size 1" and 1.5":
Brass body with chrome finish
- ❖ Size 2.5": Brass body
- ❖ Hand wheel made with steel and epoxy coated
- ❖ WP: 16 bar

Angle Valve



- ❖ Size 1.5": Brass body
- ❖ Hand wheel with steel epoxy coated
- ❖ UL/FM (Optional)

Plastic Nozzle



- ❖ 3 way control
(Jet - Spray - Shut off)

Ball Valve & Nipple



- ❖ Size: 1"
- ❖ Body: Chrome plated

Pressure Restricting Angle Valve



- ❖ Size 1.5": Brass body
- ❖ Hand wheel with steel epoxy coated
- ❖ UL/FM (Optional)

EN 671 Approved Hose Reels are provided with

- * Plastic Nozzle (Model A) and 1" Ball Valve & Nipple.

Synthetic Fire Hose Reel and Accessories



SFFECO Fire Hose is a premium, firefighting-grade hose engineered for superior performance in the most demanding conditions. Developed to withstand the rigorous requirements of fire department operations, it offers exceptional durability, flexibility, and reliability, ensuring consistent performance during critical firefighting and emergency response situations.

Item	Specification
Hose Size	1.5" (40 mm) / 2.5" (65 mm)
Approval	Standard / UL Listed
Hose Length	30 Meter (Other sizes are available on request)
Lining Material	Natural Rubber Compound / Polyurethane
Lining Color	Black / Transparence
Working Pressure	16 bar
Testing Pressure	25 bar
Min Bursting Pressure	50 bar
Coupling	Aluminum Anodized NST Coupling



Hose Size / Diameter		1.5" (40 mm)	2.5" (65mm)
Actual Diameter		38mm - 40mm	63.5mm - 65.5mm
Max. Weight without Coupling		160 Gram/mtr.	550 Gram/mtr.
Jacket	Weaving Method	Plain Weaving / Twill Weaving	
	Warp	Polyester Spun Yarn / Polyester Filament	
	Weft	Polyester Filament	
	Stripe	Without	
	Colour	White	

Nozzle - Model A



- ❖ Size 1.5" & 2.5"
- ❖ Jet Brass Nozzle

Nozzle - Model B



- ❖ Adjusted Brass Branch Nozzle
- ❖ Optional UL Listed

Coupling



- ❖ NST Couplings (Standard)

Coupling



- ❖ John Moris or Quick Couplings (Optional)

Hose with other size or specifications are available upon requirement.
 * Hose is provided with Aluminum Anodized NST Coupling;
 Other type of couplings are also available upon request.

Fire Cabinets

Design and Finish



Material and Finish

Full Stainless Steel Construction (Door, Frame & Backbox)

- ❖ Finish : Hairline / Mirror finish
- ❖ Thickness : 0.9mm / 1mm / 1.2mm / 1.5mm / 2mm

Full Mild Steel Construction (Door, Frame & Backbox)

- ❖ Finish : Red / as per customer request
- ❖ Thickness : 0.9mm / 1mm / 1.2mm / 1.5mm / 2mm

Backbox in Mild Steel

- ❖ Finish : Red / as per customer request
- ❖ Thickness : 0.9mm / 1mm / 1.2mm / 1.5mm / 2mm

Door and Frame in Stainless Steel

- ❖ Finish : Hairline / Mirror finish
- ❖ Thickness : 0.9mm / 1mm / 1.2mm / 1.5mm / 2mm

Trim

- Flat Trim cabinet
- Curved Trim cabinet

Mounting Type

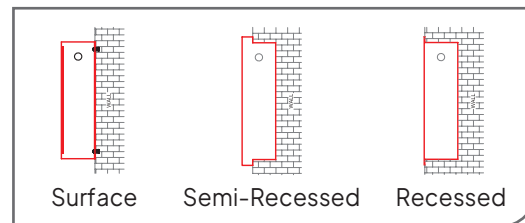

Door Opening Type

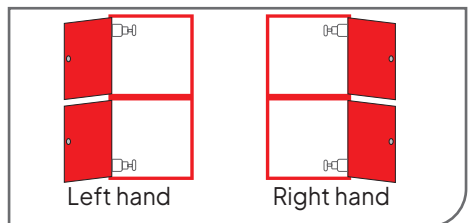

Door Selection

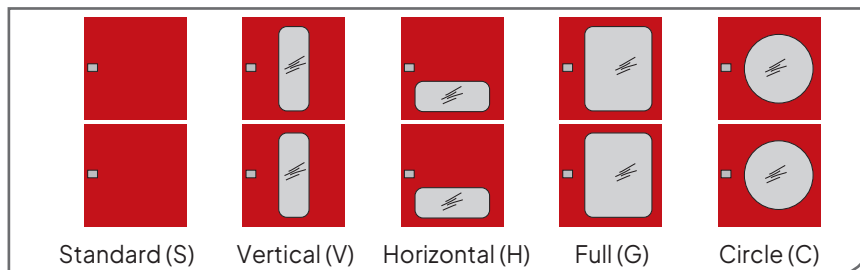

Base Type

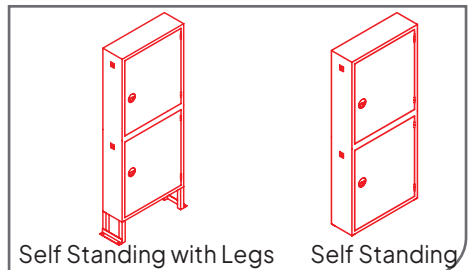

Glass Selection

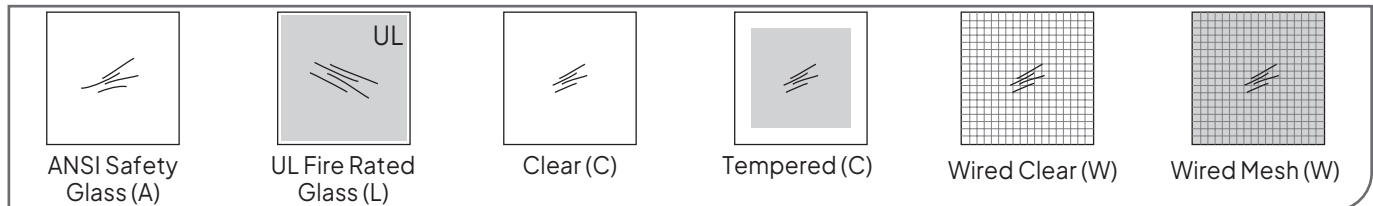

شركة المصنع السعودي لأجهزة الإطفاء SAUDI FACTORY FOR FIRE EQUIPMENT Co.

FACTORY & HEAD OFFICE - RIYADH

2nd Industrial Area, Al-Kharj Road, Riyadh, KSA, P.O. Box: 58469, Riyadh 11515
Tel : +966 11 2650070, E-mail: riyadh@sffeco.com.sa

JEDDAH BRANCH

P.O. Box: 16769, Jeddah – 21474, KSA
Tel : +966 12 670 6009,
E-mail: jeddah@sffeco.com.sa

DAMMAM BRANCH

P.O. Box: 7162, Dammam – 31462, KSA
Tel : +966 13 8351961,
E-mail: dammam@sffeco.com.sa

MADINAH BRANCH

Tel : 0148660959, 0148283256,
E-mail: madinah@sffeco.com.sa



WWW.
SFFECO.com